

MUELLER INDUSTRIES

Copper Tubing

MUELLER®
INDUSTRIES, INC.

ACR Copper Tubes



20 foot lengths

Mfg Part No	O.D.	Wall Thickness
3/8 ACR	3/8"	0.030"
1/2 ACR	1/2"	0.035"
5/8 ACR	5/8"	0.040"
3/4 ACR	3/4"	0.042"
7/8 ACR	7/8"	0.045"
1-1/8 ACR	1 1/8"	0.050"
1-3/8 ACR	1 3/8"	0.055"
1-5/8 ACR	1 3/8"	0.060"
2-1/8 ACR	2 1/8"	0.070"

Refrigeration Service Tubing

MUELLER®
INDUSTRIES, INC.

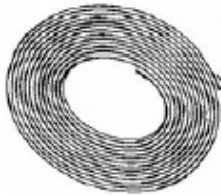

Mfg Part No	O.D.	Length	Wall Thickness
1/4" X 50'	1/4"	50'	.030"
5/16" X 50'	5/16"	50'	.032"
3/8" X 50'	3/8"	50'	.032"
1/2" X 50'	1/2"	50'	.032"
5/8" X 50'	5/8"	50'	.035"
3/4" X 50'	3/4"	50'	.035"
7/8" X 50'	7/8"	50'	.045"
1-1/8" X 50'	1 1/8"	50'	.050"

CycleMaster Ball Valves

MUELLER®
INDUSTRIES, INC.



Mueller advantages:

- Full port construction from sizes 1/4" through 31/8" to match line size I.D.
- Chromium plated ball reduces frictional wear, extends seal life and is an environmentally friendly component.
- Exclusive MCM™ seals that provide industry leading longevity and immeasurably low leak rates.
- Quick-turn cap provides visual identification of stem position and enhances serviceability in tight spaces.
- Flexible body forging that allows optional surface mount configuration.
- Dual pin stops.
- Optional features include access ports, drilled and tapped, one-piece seal caps and 3-way body styles.
- Compatible with all CFC, HCFC, and HFC refrigerants and oils.
- Wide operating temperature range of -40°F to 300°F, and working pressures up to 700 psig.
- All valves are 100% tested, UL/CUL listed and CE certified.

Mfg Part No	Size (inch)	Weight (lb)
A 17860	3/8	.630
A 17861	1/2	.620
A 17862	5/8	.640
A 17864	7/8	1.532
A 17865	1 1/8	2.926
A 17866	1 3/8	3.487
A 17867	1 5/8	5.026
A 17868	2 1/8	8.600

MUELLER INDUSTRIES

Albany, NY	518-489-0010	Rochester, NY	585-482-3876	Allentown, PA	610-437-9818	Scranton, PA	570-346-1565
Binghamton, NY	607-724-2451	Syracuse, NY	315-475-3131	Altoona, PA	814-941-7617	Stroudsburg, PA	570-424-5724
Buffalo, NY	716-853-1291	Utica, NY	315-732-4077	Erie, PA	814-459-4559	Wilkes-Barre, PA	570-824-8779
Middletown, NY	845-733-5666			Harrisburg, PA	717-558-0828	Williamsport, PA	570-323-4606

MUELLER INDUSTRIES

Copper Fittings - Wrot & Cast

Adapter

Female

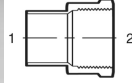

Mfg Part No	Size (in)		Box	Weight (lb)
	C	F		
W 01204	1/4	1/2	100	0.11
W 01205	1/4	3/8	100	0.05
W 01206	1/4	1/4	100	0.04
W 01207	1/4	1/8	100	0.03
W 01214	3/8	3/8	50	0.06
W 01215	3/8	1/4	50	0.04
W 01216	3/8	1/8	100	0.03
W 01223	1/2	3/4	50	0.13
W 01224	1/2	1/2	50	0.10
W 01225	1/2	3/8	50	0.06
W 01226	1/2	1/4	50	0.05
W 01230	5/8	3/4	25	0.16
W 01231	5/8	1/2	50	0.10
W 01232	5/8	3/8	50	0.07
W 01233	5/8	1/4	50	0.06
W 01238	3/4	3/4	50	0.15
W 01239	3/4	1/2	50	0.09
W 01245	7/8	1	25	0.24
W 01246	7/8	3/4	25	0.14
W 01247	7/8	1/2	25	0.11
W 01261	1-1/8	1-1/4	10	0.28
W 01263	1-1/8	1	25	0.25
W 01264	1-1/8	3/4	25	0.22
W 01265	1-1/8	1/2	20	0.24
W 01270	1-3/8	1-1/2	10	0.51
W 01271	1-3/8	1-1/4	10	0.46
W 01272	1-3/8	1	10	0.34
W 01278	1-5/8	2	-	0.71
W 01279	1-5/8	1-1/2	10	0.53
W 01280	1-5/8	1-1/4	5	0.41
W 01287	2-1/8	2	-	0.53
W 01288	2-1/8	1-1/2	5	0.74
W 01296	2-5/8	2-1/2	-	1.16
W 01297	3-1/8	3	-	1.88

MUELLER[®]
INDUSTRIES, INC.

Male

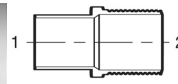

Mfg Part No	Size (in)		Box	Weight (lb)
	C	M		
W 01105	1/4	3/8	50	0.06
W 01106	1/4	1/4	50	0.03
W 01107	1/4	1/8	50	0.02
W 01109	5/16	3/8	50	0.07
W 01110	5/16	1/4	50	0.03
W 01113	3/8	1/2	50	0.09
W 01114	3/8	3/8	50	0.06
W 01115	3/8	1/4	50	0.03
W 01116	3/8	1/8	50	0.02
W 01123	1/2	3/4	25	0.17
W 01124	1/2	1/2	50	0.09
W 01125	1/2	3/8	50	0.06
W 01126	1/2	1/4	50	0.06
W 01129	5/8	1	15	0.29
W 01130	5/8	3/4	25	0.17
W 01131	5/8	1/2	50	0.08
W 01132	5/8	3/8	50	0.06
W 01133	5/8	1/4	25	0.06
W 01138	3/4	3/4	25	0.14
W 01139	3/4	1/2	25	0.12
W 01145	7/8	1	10	0.29
W 01146	7/8	3/4	25	0.13
W 01147	7/8	1/2	25	0.12
W 01161	1-1/8	1-1/2	10	0.52
W 01162	1-1/8	1 1/4	10	0.41
W 01163	1-1/8	1	10	0.24
W 01164	1-1/8	3/4	10	0.18
W 01165	1-1/8	1/2	10	0.18
W 01170	1-3/8	1-1/2	10	0.51
W 01171	1-3/8	1-1/4	10	0.41
W 01172	1-3/8	1	10	0.24
W 01173	1-3/8	3/4	10	0.22
W 01178	1-5/8	2	-	0.75
W 01179	1-5/8	1-1/2	10	0.51
W 01180	1-5/8	1-1/4	10	0.38
W 01181	1-5/8	1	10	0.38
W 01187	2-1/8	2	5	0.62
W 01188	2-1/8	1-1/2	-	0.64
W 01189	2-1/8	1-1/4	-	0.57
W 01196	2-5/8	2-1/2	-	1.22
W 01197	2-5/8	2	-	0.98
W 01198	2-5/8	1-1/2	-	0.97
W 01199	3-1/8	3	-	1.56
W 01150	4-1/8	4	-	3.71

MUELLER INDUSTRIES



MUELLER INDUSTRIES

Copper Fittings - Wrot & Cast

Bushing

Flush

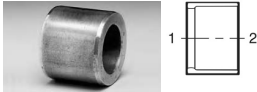

Mfg Part No	Size (in)		Box	Weight (lb)
	FTG	C		
W 01706	3/8	1/4	100	0.01
W 01712	1/2	3/8	100	0.01
W 01714	1/2	1/4	100	0.02
W 01715	5/8	1/2	100	0.02
W 01717	5/8	3/8	100	0.04
W 01720	3/4	5/8	50	0.03
W 01721	3/4	1/2	50	0.06
W 01722	3/4	3/8	50	0.08
W 01725	7/8	3/4	50	0.04
W 01726	7/8	5/8	50	0.08
W 01727	7/8	1/2	50	0.11
W 01737	1-1/8	7/8	50	0.12
W 01738	1-1/8	3/4	50	0.18
W 01739	1-1/8	5/8	25	0.22
W 01743	1-3/8	1-1/8	10	0.16
W 01745	1-3/8	7/8	10	0.30
W 01750	1-5/8	1-3/8	10	0.22
W 01751	1-5/8	1-1/8	10	0.41
W 01758	2-1/8	1-5/8	10	0.68
W 01759	2-1/8	1-3/8	5	0.95
W 01767	2-5/8	2-1/8	-	0.92

Flush - Brass



Mfg Part No	Size (in)		Box	Weight (lb)
	FTG	F		
A 07812	5/8	1/8	100	0.04
A 07813	5/8	1/4	50	0.02
A 07814	7/8	3/8	50	0.08
A 07815	1-1/8	1/2	50	0.17
A 07816	1-3/8	3/4	10	0.25
A 07817	1-5/8	1	10	0.34
A 07819	2-1/8	1-1/2	10	0.48

Cap

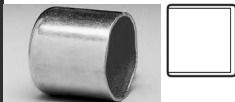

Mfg Part No	Size (in)	Box	Weight (lb)
W 07002	1/4	50	0.01
W 07004	3/8	50	0.01
W 07006	1/2	50	0.01
W 07007	5/8	100	0.02

W 07008	3/4	50	0.03
W 07009	7/8	50	0.04
W 07011	1-1/8	50	0.08
W 07012	1-3/8	25	0.11
W 07013	1-5/8	25	0.18
W 07014	2-1/8	-	0.30
W 07015	2-5/8	-	0.48
W 07016	3-1/8	-	0.73
W 07017	3-5/8	-	1.15
W 07018	4-1/8	-	1.50

Coupling

No Stop

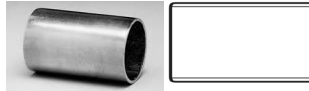

Mfg Part No	Size (in)	Box	Weight (lb)
W 01900	1/4	100	0.01
W 01901	3/8	50	0.01
W 01902	1/2	50	0.01
W 01903	5/8	100	0.03
W 01904	3/4	25	0.04
W 01905	7/8	50	0.06
W 01906	1-1/8	25	0.11
W 01907	1-3/8	25	0.15
W 01908	1-5/8	10	0.22
W 01909	2-1/8	-	0.40
W 01910	2-5/8	-	0.81
W 01911	3-1/8	-	1.03
W 01913	4-1/8	-	2.07

Rolled Stop



Mfg Part No	Size (in)	Box	Weight (lb)
W 01000	1/8	100	0.01
W 01001	3/16	100	0.01
W 01003	1/4	100	0.01
W 01009	3/8	50	0.01
W 01017	1/2	50	0.02
W 01022	5/8	100	0.03
W 01028	3/4	50	0.04
W 01034	7/8	50	0.06
W 01040	1	25	0.09
W 01047	1-1/8	25	0.11
W 01055	1-3/8	25	0.15
W 01062	1-1/2	-	0.22
W 01063	1-5/8	10	0.22
W 01072	2-1/8	-	0.40
W 01082	2-5/8	-	0.68
W 01092	3-1/8	-	1.03
W 10100	3-5/8	-	1.47
W 10107	4-1/8	-	2.08

MUELLER INDUSTRIES

Albany, NY	518-489-0010	Rochester, NY	585-482-3876	Allentown, PA	610-437-9818	Scranton, PA	570-346-1565
Binghamton, NY	607-724-2451	Syracuse, NY	315-475-3131	Altoona, PA	814-941-7617	Stroudsburg, PA	570-424-5724
Buffalo, NY	716-853-1291	Utica, NY	315-732-4077	Erie, PA	814-459-4559	Wilkes-Barre, PA	570-824-8779
Middletown, NY	845-733-5666			Harrisburg, PA	717-558-0828	Williamsport, PA	570-323-4606

Copper Fittings - Wrot & Cast

Coupling

Reducing

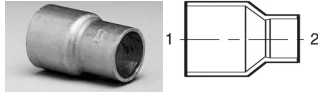

Mfg Part No	Size (in)		Box	Weight (lb)
	C	C		
W 01004	1/4	3/16	50	0.01
W 01005	1/4	1/8	50	0.01
W 01010	3/8	5/16	50	0.01
W 01011	3/8	1/4	50	0.01
W 01019	1/2	3/8	50	0.01
W 01021	1/2	1/4	50	0.02
W 01023	5/8	1/2	100	0.03
W 01025	5/8	3/8	100	0.03
W 01027	5/8	1/4	100	0.03
W 01029	3/4	5/8	100	0.04
W 01030	3/4	1/2	100	0.03
W 01031	3/4	3/8	100	0.04
W 01035	7/8	3/4	100	0.06
W 01036	7/8	5/8	50	0.08
W 01037	7/8	1/2	50	0.06
W 01038	7/8	3/8	50	0.06
W 01049	1-1/8	7/8	25	0.13
W 01050	1-1/8	3/4	25	0.11
W 01051	1-1/8	5/8	25	0.10
W 01052	1-1/8	1/2	25	0.10
W 01056	1-3/8	1-1/8	10	0.20
W 01058	1-3/8	7/8	10	0.17
W 01060	1-3/8	5/8	10	0.16
W 01064	1-5/8	1-3/8	10	0.24
W 01065	1-5/8	1-1/8	10	0.24
W 01067	1-5/8	7/8	10	0.24
W 01069	1-5/8	5/8	10	0.22
W 01073	2-1/8	1-5/8	-	0.42
W 01074	2-1/8	1-3/8	-	0.44
W 01075	2-1/8	1-1/8	-	0.44
W 01077	2-1/8	7/8	-	0.40
W 01079	2-1/8	5/8	-	0.42
W 01083	2-5/8	2-1/8	-	0.75
W 01084	2-5/8	1-5/8	-	0.75
W 01085	2-5/8	1-3/8	-	0.77
W 01086	2-5/8	1-1/8	-	0.82
W 01093	3-1/8	2-5/8	-	1.07
W 01094	3-1/8	2-1/8	-	1.10
W 01095	3-1/8	1-5/8	-	1.17
W 10101	3-5/8	3-1/8	-	1.27
W 10108	4-1/8	3-5/8	-	2.01
W 10109	4-1/8	3-1/8	-	1.69
W 10110	4-1/8	2-5/8	-	1.88
W 10111	4-1/8	2-1/8	-	1.97

45 Degree Elbow



Mfg Part No	Size (in)	Box	Weight (lb)
W 03005	1/4	50	0.01
W 03012	3/8	50	0.01
W 03021	1/2	50	0.02
W 03026	5/8	50	0.04
W 03030	3/4	50	0.06
W 03034	7/8	25	0.09
W 03044	1-1/8	25	0.15
W 03050	1-3/8	10	0.22
W 03055	1-5/8	10	0.34
W 03059	2-1/8	10	0.61
W 03063	2-5/8	5	1.00
W 03067	3-1/8	2	1.15
W 03070	3-5/8	2	2.81
W 03073	4-1/8	-	3.14

Street



Mfg Part No	Size (in)	Box	Weight (lb)
W 03312	3/8	100	0.01
W 03321	1/2	100	0.03
W 03326	5/8	50	0.04
W 03330	3/4	50	0.07
W 03334	7/8	25	0.10
W 03344	1-1/8	25	0.17
W 03350	1-3/8	10	0.23
W 03355	1-5/8	10	0.40
W 03359	2-1/8	5	0.62
W 03363	2-5/8	2	1.05
W 03368	3-1/8	2	1.84
W 03373	4-1/8	-	3.12

MUELLER[®]
INDUSTRIES, INC.

MUELLER INDUSTRIES



MUELLER INDUSTRIES

Copper Fittings - Wrot & Cast

90 Degree Elbow

Short Radius



Mfg Part No	Size (in)	Box	Weight (lb)
W 02003	1/4	50	0.01
W 02009	3/8	50	0.02
W 02017	1/2	50	0.03
W 02022	5/8	100	0.05
W 02028	3/4	50	0.10
W 02034	7/8	50	0.11
W 02040	1	20	0.21
W 02047	1-1/8	25	0.20
W 02084	1-3/8	10	0.30
W 02085	1-5/8	10	0.40
W 02086	2-1/8	10	0.75
W 02087	2-5/8	5	1.27
W 02088	3-1/8	5	2.07
W 02089	3-5/8	2	2.77
W 02090	4-1/8	2	3.96
W 02097	6-1/8	-	12.22

Reducing



Mfg Part No	Size (in)		Box	Weight (lb)
	C	C		
W 02011	3/8	1/4	50	0.02
W 02019	1/2	3/8	50	0.03
W 02023	5/8	1/2	50	0.05
W 02025	5/8	3/8	50	0.05
W 02029	3/4	5/8	50	0.06
W 02030	3/4	1/2	50	0.07
W 02035	7/8	3/4	50	0.11
W 02036	7/8	5/8	50	0.10
W 02037	7/8	1/2	50	0.11
W 02049	1-1/8	7/8	25	0.17
W 02050	1-1/8	3/4	25	0.16
W 02051	1-1/8	5/8	25	0.18
W 02052	1-1/8	1/2	25	0.20
W 02056	1-3/8	1-1/8	20	0.32
W 02077	1-5/8	1-3/8	5	0.33
W 02078	2-1/8	1-5/8	5	0.60

Long Radius



Mfg Part No	Size (in)	Box	Weight (lb)
W 02701	3/16	50	0.01
W 02715	1/4	50	0.01
W 02710	5/16	50	0.01
W 02716	3/8	50	0.02
W 02717	1/2	50	0.04
W 02722	5/8	50	0.06
W 02728	3/4	50	0.11
W 02734	7/8	25	0.13
W 02747	1-1/8	10	0.26
W 02055	1-3/8	10	0.41
W 02063	1-5/8	5	0.63
W 02072	2-1/8	5	1.22
W 02082	2-5/8	5	2.02
W 02092	3-1/8	2	3.07
W 02093	3-5/8	1	5.63
W 02095	4-1/8	-	7.95

Reducing



Mfg Part No	Size (in)		Box	Weight (lb)
	C	C		
W 02711	3/8	1/4	50	0.01
W 02719	1/2	3/8	50	0.03
W 02723	5/8	1/2	50	0.04
W 02725	5/8	3/8	50	0.03
W 02735	7/8	3/4	25	0.12
W 02736	7/8	5/8	50	0.09
W 02749	1-1/8	7/8	10	0.17
W 02756	1-3/8	1-1/8	10	0.31
W 02058	1-3/8	7/8	10	0.37
W 02060	1-3/8	5/8	10	0.37
W 02064	1-5/8	1-3/8	5	0.44
W 02065	1-5/8	1-1/8	5	0.52
W 02067	1-5/8	7/8	5	0.51
W 02073	2-1/8	1-5/8	2	0.95
W 02074	2-1/8	1-3/8	2	0.94
W 02075	2-1/8	1-1/8	2	0.97
W 02083	2-5/8	2-1/8	2	1.53

MUELLER[®]
INDUSTRIES, INC.

MUELLER INDUSTRIES

Albany, NY	518-489-0010	Rochester, NY	585-482-3876	Allentown, PA	610-437-9818	Scranton, PA	570-346-1565
Binghamton, NY	607-724-2451	Syracuse, NY	315-475-3131	Altoona, PA	814-941-7617	Stroudsburg, PA	570-424-5724
Buffalo, NY	716-853-1291	Utica, NY	315-732-4077	Erie, PA	814-459-4559	Wilkes-Barre, PA	570-824-8779
Middletown, NY	845-733-5666			Harrisburg, PA	717-558-0828	Williamsport, PA	570-323-4606

MUELLER INDUSTRIES

Copper Fittings - Wrot & Cast

90 Degree Elbow

Street Short Radius



Mfg Part No	Size (in)	Box	Weight (lb)
W 02305	1/4	50	0.01
W 02312	3/8	50	0.02
W 02321	1/2	50	0.03
W 02326	5/8	50	0.05
W 02330	3/4	25	0.10
W 02334	7/8	25	0.11
W 02344	1-1/8	25	0.21
W 02384	1-3/8	25	0.29
W 02385	1-5/8	10	0.42
W 02386	2-1/8	10	0.90
W 02387	2-5/8	5	1.08
W 02388	3-1/8	2	1.97
W 02389	3-5/8	1	2.77
W 02390	4-1/8	2	4.03

Street Long Radius



Mfg Part No	Size (in)	Box	Weight (lb)
W 02809	3/8	50	0.02
W 02817	1/2	50	0.04
W 02822	5/8	50	0.06
W 02828	3/4	25	0.11
W 02834	7/8	25	0.13
W 02847	1-1/8	10	0.26
W 02350	1-3/8	10	0.42
W 02355	1-5/8	5	0.59
W 02359	2-1/8	5	1.22
W 02363	2-5/8	5	2.05
W 02368	3-1/8	2	3.01
W 02393	3-5/8	1	5.52
W 02395	4-1/8	-	7.80

Forged Brass

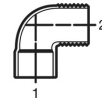

Mfg Part No	Size (in)		Box	Weight (lb)
	C	M		
W 02106	1/4	1/4	50	0.07
W 02107	1/4	1/8	50	0.04
W 02113	3/8	1/2	25	0.16
W 02114	3/8	3/8	50	0.10
W 02115	3/8	1/4	50	0.06
W 02116	3/8	1/8	50	0.06
W 02123	1/2	3/4	10	0.22
W 02124	1/2	1/2	25	0.13
W 02125	1/2	3/8	25	0.10
W 02126	1/2	1/4	25	0.09
W 02130	5/8	3/4	10	0.22
W 02131	5/8	1/2	10	0.17
W 02132	5/8	3/8	10	0.16
W 02137	3/4	1	10	0.90
W 02138	3/4	3/4	10	0.22
W 02146	7/8	3/4	10	0.31
W 02147	7/8	1/2	15	0.24
W 02148	7/8	3/8	12	0.24
W 02163	1-1/8	1	10	0.45
W 02164	1-1/8	3/4	10	0.44

MUELLER[®]
INDUSTRIES, INC.

MUELLER INDUSTRIES



MUELLER INDUSTRIES

Copper Fittings - Wrot & Cast

Fitting Reducer

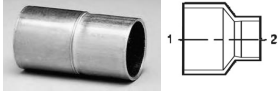

Mfg Part No	Size (in)		Box	Weight (lb)
	FTG	C		
W 01302	1/4	1/8	50	0.01
W 01306	3/8	1/4	50	0.01
W 01312	1/2	3/8	50	0.01
W 01314	1/2	1/4	50	0.01
W 01315	5/8	1/2	50	0.02
W 01317	5/8	3/8	50	0.02
W 01320	3/4	5/8	100	0.04
W 01321	3/4	1/2	100	0.03
W 01322	3/4	3/8	100	0.03
W 01325	7/8	3/4	50	0.06
W 01326	7/8	5/8	50	0.06
W 01327	7/8	1/2	50	0.05
W 01337	1-1/8	7/8	25	0.11
W 01338	1-1/8	3/4	25	0.10
W 01339	1-1/8	5/8	25	0.09
W 01340	1-1/8	1/2	20	0.08
W 01343	1-3/8	1-1/8	10	0.17
W 01345	1-3/8	7/8	10	0.17
W 01347	1-3/8	5/8	10	0.15
W 01350	1-5/8	1-3/8	10	0.23
W 01351	1-5/8	1-1/8	10	0.24
W 01353	1-5/8	7/8	10	0.24
W 01355	1-5/8	5/8	10	0.20
W 01358	2-1/8	1-5/8	-	0.44
W 01359	2-1/8	1-3/8	-	0.43
W 01360	2-1/8	1-1/8	-	0.45
W 01362	2-1/8	7/8	-	0.36
W 01364	2-1/8	5/8	-	0.42
W 01367	2-5/8	2-1/8	-	0.57
W 01368	2-5/8	1-5/8	-	0.57
W 01369	2-5/8	1-3/8	-	0.62
W 01370	2-5/8	1-1/8	-	0.63
W 01376	3-1/8	2-5/8	-	1.00
W 01377	3-1/8	2-1/8	-	1.03
W 01378	3-1/8	1-5/8	-	1.05
W 01379	3-1/8	1-3/8	-	1.14
W 01381	3-5/8	3-1/8	-	1.32
W 01382	3-5/8	2-5/8	-	1.37
W 01383	3-5/8	2-1/8	-	1.47
W 01386	4-1/8	3-5/8	-	1.78
W 01387	4-1/8	3-1/8	-	1.73
W 01388	4-1/8	2-5/8	-	1.91
W 01389	4-1/8	2-1/8	-	1.81

P-Trap

Suction Line



Mfg Part No	Size (in)	Box	Weight (lb)
W 60999	5/8	10	0.36
W 61008	3/4	10	0.45
W 61000	7/8	5	0.58
W 61001	1-1/8	3	0.84
W 61002	1-3/8	4	1.16
W 61003	1-5/8	4	2.32
W 61009	2-1/8	-	3.93

Tee

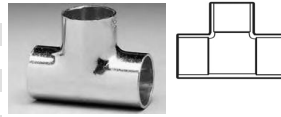

Mfg Part No	Size (in)	Box	Weight (lb)
W 40302	3/16	50	0.01
W 40306	1/4	100	0.01
W 40313	5/16	50	0.02
W 04000	3/8	50	0.02
W 04001	1/2	50	0.04
W 04006	5/8	50	0.06
W 04017	3/4	25	0.11
W 04031	7/8	25	0.17
W 04048	1-1/8	10	0.30
W 04068	1-3/8	5	0.52
W 04084	1-5/8	5	0.70
W 40102	2-1/8	5	1.60
W 40123	2-5/8	2	2.10
W 40152	3-1/8	2	3.76
W 40190	3-5/8	1	5.66
W 40200	4-1/8	1	7.94
W 40400	5-1/8	-	12.38
W 40500	6-1/8	-	16.07

MUELLER[®]
INDUSTRIES, INC.

MUELLER INDUSTRIES

Albany, NY	518-489-0010	Rochester, NY	585-482-3876	Allentown, PA	610-437-9818	Scranton, PA	570-346-1565
Binghamton, NY	607-724-2451	Syracuse, NY	315-475-3131	Altoona, PA	814-941-7617	Stroudsburg, PA	570-424-5724
Buffalo, NY	716-853-1291	Utica, NY	315-732-4077	Erie, PA	814-459-4559	Wilkes-Barre, PA	570-824-8779
Middletown, NY	845-733-5666			Harrisburg, PA	717-558-0828	Williamsport, PA	570-323-4606

MUELLER INDUSTRIES



Mfg Part No	Size (in)			Box	Weight (lb)
	C	C	C		
W 40368	1/4	1/4	3/8	50	0.03
W 40308	1/4	1/4	3/16	50	0.01
W 40334	5/16	5/16	3/8	50	0.03
W 04016	3/8	3/8	5/8	50	0.08
W 04005	3/8	3/8	1/2	50	0.04
W 40324	3/8	3/8	1/4	50	0.02
W 40330	3/8	1/4	3/8	50	0.03
W 40332	3/8	1/4	1/4	50	0.03
W 04015	1/2	1/2	5/8	50	0.09
W 04002	1/2	1/2	3/8	50	0.04
W 40350	1/2	1/2	1/4	50	0.04
W 04003	1/2	3/8	1/2	50	0.05
W 04004	1/2	3/8	3/8	50	0.04
W 40358	1/2	3/8	1/4	50	0.04
W 40363	1/2	1/4	1/2	50	0.05
W 40364	1/2	1/4	3/8	50	0.05
W 40366	1/2	1/4	1/4	50	0.04
W 04067	5/8	5/8	1/8	10	0.36
W 04047	5/8	5/8	7/8	25	0.15
W 04029	5/8	5/8	3/4	25	0.10
W 04007	5/8	5/8	1/2	50	0.09
W 04008	5/8	5/8	3/8	50	0.08
W 04014	5/8	5/8	1/4	50	0.09
W 04009	5/8	1/2	5/8	50	0.09
W 04010	5/8	1/2	1/2	50	0.08
W 04011	5/8	1/2	3/8	50	0.09
W 04012	5/8	3/8	5/8	50	0.09
W 40367	5/8	3/8	1/2	50	0.08
W 04013	5/8	3/8	3/8	50	0.09
W 04046	3/4	3/4	7/8	25	0.15
W 04018	3/4	3/4	5/8	25	0.10
W 04019	3/4	3/4	1/2	25	0.10
W 04020	3/4	3/4	3/8	25	0.10
W 04021	3/4	5/8	3/4	25	0.15
W 04022	3/4	5/8	5/8	25	0.11
W 04023	3/4	5/8	1/2	25	0.11
W 04025	3/4	1/2	3/4	25	0.15
W 04026	3/4	1/2	5/8	25	0.14
W 04027	3/4	1/2	1/2	25	0.11
W 04065	7/8	7/8	1/8	10	0.26
W 04032	7/8	7/8	3/4	25	0.17
W 04033	7/8	7/8	5/8	25	0.14
W 04034	7/8	7/8	1/2	25	0.14
W 04035	7/8	7/8	3/8	25	0.14
W 04036	7/8	3/4	7/8	25	0.17
W 04037	7/8	3/4	3/4	25	0.17
W 04041	7/8	5/8	7/8	25	0.18
W 04042	7/8	5/8	3/4	25	0.17
W 04043	7/8	5/8	5/8	25	0.14
W 04044	7/8	5/8	1/2	25	0.15
W 04045	7/8	5/8	3/8	25	0.15
W 40230	7/8	1/2	7/8	25	0.17
W 40231	7/8	1/2	5/8	25	0.15
W 40232	7/8	1/2	1/2	25	0.15

W 40101	1-1/8	1-1/8	1-5/8	5	0.74
W 04082	1-1/8	1-1/8	1-3/8	5	0.45
W 04049	1-1/8	1-1/8	7/8	10	0.24
W 04050	1-1/8	1-1/8	3/4	10	0.27
W 04051	1-1/8	1-1/8	5/8	10	0.21
W 04052	1-1/8	1-1/8	1/2	10	0.22
W 04055	1-1/8	7/8	1-1/8	10	0.32
W 04056	1-1/8	7/8	7/8	10	0.25
W 04057	1-1/8	7/8	3/4	10	0.43
W 04058	1-1/8	7/8	5/8	10	0.22
W 04059	1-1/8	7/8	1/2	10	0.35
W 40233	1-1/8	3/4	1-1/8	10	0.33
W 40234	1-1/8	3/4	7/8	10	0.30
W 40235	1-1/8	3/4	3/4	10	0.31
W 40236	1-1/8	3/4	5/8	10	0.35
W 04061	1-1/8	5/8	1-1/8	10	0.34
W 04062	1-1/8	5/8	7/8	10	0.32
W 04063	1-1/8	5/8	5/8	10	0.21
W 40122	1-3/8	1-3/8	2-1/8	2	1.40
W 40100	1-3/8	1-3/8	1-5/8	5	0.73
W 04069	1-3/8	1-3/8	1-1/8	5	0.51
W 04070	1-3/8	1-3/8	7/8	5	0.34
W 04071	1-3/8	1-3/8	5/8	5	0.29
W 04072	1-3/8	1-3/8	1/2	5	0.29
W 04073	1-3/8	1-1/8	1-3/8	5	0.55
W 04074	1-3/8	1-1/8	1-1/8	5	0.55
W 04075	1-3/8	1-1/8	7/8	5	0.38
W 04076	1-3/8	1-1/8	5/8	5	0.53
W 04078	1-3/8	7/8	1-3/8	5	0.56
W 04079	1-3/8	7/8	1-1/8	5	0.55
W 04080	1-3/8	7/8	7/8	5	0.37
W 04081	1-3/8	7/8	5/8	5	0.31
W 04083	1-3/8	5/8	1-3/8	5	0.57
W 40121	1-5/8	1-5/8	2-1/8	5	1.10
W 04085	1-5/8	1-5/8	1-3/8	5	0.66
W 04086	1-5/8	1-5/8	1-1/8	5	0.52
W 04087	1-5/8	1-5/8	7/8	5	0.47
W 04088	1-5/8	1-5/8	5/8	5	0.38
W 04089	1-5/8	1-5/8	1/2	5	0.58
W 04090	1-5/8	1-3/8	1-5/8	5	0.77
W 04091	1-5/8	1-3/8	1-3/8	5	0.71
W 04092	1-5/8	1-3/8	1-1/8	5	0.56
W 04093	1-5/8	1-3/8	7/8	5	0.49
W 04094	1-5/8	1-3/8	5/8	5	0.51
W 04095	1-5/8	1-1/8	1-5/8	5	0.76
W 04096	1-5/8	1-1/8	1-3/8	5	0.73
W 04097	1-5/8	1-1/8	1-1/8	5	0.55
W 04098	1-5/8	1-1/8	7/8	5	0.52
W 40237	1-5/8	1-1/8	5/8	5	0.38
W 04099	1-5/8	7/8	1-5/8	5	0.78
W 40239	1-5/8	7/8	1-3/8	5	0.75
W 40240	2-1/8	7/8	1-1/8	5	0.52
W 40238	2-1/8	7/8	7/8	5	0.46
W 40243	2-1/8	7/8	5/8	5	0.58
W 40244	2-1/8	5/8	1-5/8	5	0.78
W 40153	2-1/8	2-1/8	3-1/8	1	2.55
W 40144	2-1/8	2-1/8	2-5/8	1	2.30
W 40103	2-1/8	2-1/8	1-5/8	5	1.21
W 40104	2-1/8	2-1/8	1-3/8	5	0.85
W 40105	2-1/8	2-1/8	1-1/8	5	0.92
W 40106	2-1/8	2-1/8	7/8	5	0.77
W 40107	2-1/8	2-1/8	5/8	5	0.67
W 40108	2-1/8	2-1/8	1/2	2	0.68
W 40109	2-1/8	1-5/8	2-1/8	2	1.59

MUELLER INDUSTRIES



MUELLER INDUSTRIES

Copper Fittings - Wrot & Cast

Tee

Reducing

Mfg Part No	Size (in)			Box	Weight (lb)
	C	C	C		
W 40110	2-1/8	1-5/8	1-5/8	2	1.22
W 40111	2-1/8	1-5/8	1-3/8	2	0.87
W 40112	2-1/8	1-5/8	1-1/8	2	0.99
W 40113	2-1/8	1-5/8	7/8	2	0.75
W 40114	2-1/8	1-5/8	5/8	2	0.64
W 40115	2-1/8	1-3/8	2-1/8	2	1.87
W 40116	2-1/8	1-3/8	1-5/8	2	1.25
W 40117	2-1/8	1-3/8	1-3/8	2	0.87
W 40118	2-1/8	1-3/8	1-1/8	2	0.95
W 40119	2-1/8	1-3/8	7/8	5	0.76
W 40120	2-1/8	1-3/8	5/8	5	0.64
W 40245	2-1/8	1-1/8	2-1/8	5	1.69
W 40247	2-1/8	1-1/8	1-1/8	5	0.96
W 40248	2-1/8	7/8	2-1/8	5	1.57
W 40249	2-1/8	5/8	2-1/8	5	1.66
W 40124	2-5/8	2-5/8	2-1/8	2	1.77
W 40125	2-5/8	2-5/8	1-5/8	2	1.87
W 40126	2-5/8	2-5/8	1-3/8	2	1.90
W 40127	2-5/8	2-5/8	1-1/8	2	1.91
W 40128	2-5/8	2-5/8	7/8	1	1.94
W 40129	2-5/8	2-5/8	5/8	1	2.05
W 40130	2-5/8	2-1/8	2-5/8	4	2.24
W 40131	2-5/8	2-1/8	2-1/8	2	1.84
W 40132	2-5/8	2-1/8	1-5/8	4	2.09
W 40133	2-5/8	2-1/8	1-3/8	4	2.12
W 40134	2-5/8	2-1/8	1-1/8	4	2.10
W 40135	2-5/8	2-1/8	7/8	4	2.06
W 40136	2-5/8	2-1/8	5/8	4	2.20
W 40137	2-5/8	1-5/8	2-5/8	4	2.30
W 40138	2-5/8	1-5/8	2-1/8	4	1.84
W 40139	2-5/8	1-5/8	1-5/8	4	2.11
W 40140	2-5/8	1-5/8	1-3/8	4	2.17
W 40141	2-5/8	1-5/8	1-1/8	4	1.83
W 40142	2-5/8	1-5/8	7/8	4	2.36
W 40143	2-5/8	1-5/8	5/8	4	2.36
W 40220	2-5/8	1-3/8	2-5/8	4	2.35
W 40250	2-5/8	1-3/8	2-1/8	4	1.82
W 40251	2-5/8	1-3/8	1-5/8	4	2.47
W 40252	2-5/8	1-3/8	1-3/8	4	1.96
W 40253	2-5/8	1-3/8	1-1/8	4	2.47
W 40254	2-5/8	1-3/8	7/8	4	2.18
W 40255	2-5/8	1-3/8	5/8	4	2.47
W 40221	2-5/8	1-1/8	2-5/8	4	2.46
W 40256	2-5/8	1-1/8	2-1/8	4	1.97
W 40257	2-5/8	1-1/8	1-5/8	4	2.15
W 40258	2-5/8	1-1/8	1-3/8	4	2.04
W 40259	2-5/8	1-1/8	1-1/8	4	2.27
W 40222	2-5/8	7/8	2-5/8	4	2.41
W 40151	3-1/8	3-1/8	2-5/8	2	4.23
W 40150	3-1/8	3-1/8	2-1/8	2	2.28
W 40149	3-1/8	3-1/8	1-5/8	2	2.38
W 40148	3-1/8	3-1/8	1-3/8	2	2.38
W 40147	3-1/8	3-1/8	1-1/8	2	1.82
W 40146	3-1/8	3-1/8	7/8	2	1.85
W 40145	3-1/8	3-1/8	5/8	2	1.87
W 40159	3-1/8	2-5/8	3-1/8	2	4.12

W 40158	3-1/8	2-5/8	2-5/8	2	4.52
W 40157	3-1/8	2-5/8	2-1/8	2	2.48
W 40156	3-1/8	2-5/8	1-5/8	2	2.63
W 40155	3-1/8	2-5/8	1-3/8	2	2.62
W 40154	3-1/8	2-5/8	1-1/8	2	2.02
W 40167	3-1/8	2-1/8	3-1/8	2	4.17
W 40165	3-1/8	2-1/8	2-5/8	2	4.64
W 40164	3-1/8	2-1/8	2-1/8	2	2.52
W 40163	3-1/8	2-1/8	1-5/8	2	2.57
W 40162	3-1/8	2-1/8	1-3/8	2	2.61
W 40161	3-1/8	2-1/8	1-1/8	2	2.04
W 40174	3-1/8	1-5/8	3-1/8	2	4.27
W 40181	3-1/8	1-3/8	3-1/8	2	4.33
W 40178	3-1/8	1-1/8	3-1/8	2	4.39
W 40179	3-1/8	7/8	3-1/8	2	4.43
W 40198	4-1/8	4-1/8	3-1/8	1	4.94
W 40197	4-1/8	4-1/8	2-5/8	1	5.16
W 40196	4-1/8	4-1/8	2-1/8	1	4.11
W 40195	4-1/8	4-1/8	1-5/8	1	4.47
W 40194	4-1/8	4-1/8	1-3/8	1	4.55
W 40193	4-1/8	4-1/8	1-1/8	1	3.94
W 40192	4-1/8	4-1/8	7/8	1	3.40
W 40191	4-1/8	4-1/8	5/8	1	3.44
W 40208	4-1/8	3-1/8	4-1/8	1	8.66
W 40206	4-1/8	3-1/8	3-1/8	1	5.37
W 40205	4-1/8	3-1/8	2-5/8	1	5.61
W 40204	4-1/8	3-1/8	2-1/8	1	4.76
W 40212	4-1/8	2-5/8	4-1/8	1	8.61
W 40216	4-1/8	2-1/8	4-1/8	1	8.95
W 40215	4-1/8	1-5/8	4-1/8	1	8.51
W 40214	4-1/8	1-3/8	4-1/8	1	8.57
W 40213	4-1/8	1-1/8	4-1/8	1	9.33
W 40503	6-1/8	6-1/8	3-1/8	-	10.61
W 40504	6-1/8	6-1/8	2-5/8	-	10.67
W 40505	6-1/8	6-1/8	2-1/8	-	10.87

Union



Mfg Part No	Size (in)	Box	Weight (lb)
W 08001	3/8	25	0.12
W 08002	1/2	25	0.11
W 08003	5/8	25	0.16
W 08004	7/8	25	0.37
W 08005	1-1/8	10	0.51

MUELLER[®]
INDUSTRIES, INC.

MUELLER INDUSTRIES

Albany, NY	518-489-0010	Rochester, NY	585-482-3876	Allentown, PA	610-437-9818	Scranton, PA	570-346-1565
Binghamton, NY	607-724-2451	Syracuse, NY	315-475-3131	Altoona, PA	814-941-7617	Stroudsburg, PA	570-424-5724
Buffalo, NY	716-853-1291	Utica, NY	315-732-4077	Erie, PA	814-459-4559	Wilkes-Barre, PA	570-824-8779
Middletown, NY	845-733-5666			Harrisburg, PA	717-558-0828	Williamsport, PA	570-323-4606

Copper Fittings - Wrot & Cast

Copper Tube Strap

2-Hole



Mfg Part No	Size (in)	Box	Weight (lb)
A 01203	1/4	100	0.01
A 01278	3/8	100	0.01
A 01366	1/2	100	0.01
A 02529	5/8	100	0.01
A 01467	3/4	100	0.01
A 02574	7/8	50	0.01
A 02614	1-1/8	50	0.02
A 02650	1-3/8	50	0.04
A 02675	1-5/8	50	0.05
A 02708	2-1/8	50	0.06

Perforated Copper Strap



Mfg Part No	Size	Box	Weight (lb)
A 01211	25 Ft Roll	1	1.63

MUELLER[®]
INDUSTRIES, INC.

MUELLER INDUSTRIES