

STANDARD REFRIGERATION

Water Cooled Condensers



SST Series High Pumpdown Shell & Tube Condensers



FEATURES:

- Industry's most widely used and trusted model
- Heavy duty, horizontal, shell and tube design
- Nominal ratings and sizes to handle the most demanding requirements
- Removable, epoxy coated, water plates to facilitate cleaning
- All copper, heavy wall, straight tube water channels
- Epoxy coated tube sheets to prevent pitting caused by galvanic action
- Generous pumpdown capacities
- Custom models available thru 800 horsepower
- 28 SST models, 3/4 thru 200 horsepower

Mfg Part No	Nom. HP	Dia.	Length	Refrig. (IDS)		Water (FPT)
				Inlet	Outlet	
SST-75A	3/4	5"	20 7/8"	1/2"	1/2"	3/8"
SST-100A	1	6"	21 3/8"	5/8"	1/2"	1/2"
SST-200A	2	6 5/8"	21 3/8"	7/8"	5/8"	3/4"
SST-300A	3	6 5/8"	21 3/8"	7/8"	5/8"	3/4"
SST-500A	5	8 5/8"	28"	1 1/8"	5/8"	1 1/4"
SST-750A	7 1/2	8 5/8"	28 1/2"	1 3/8"	7/8"	1 1/4"
SST-755A	7 1/2	8 5/8"	40 1/2"	1 3/8"	7/8"	1 1/4"
SST-1000A	10	8 5/8"	46 1/2"	1 3/8"	7/8"	1 1/4"
SST-1500A	15	8 5/8"	52"	1 3/8"	1 1/8"	1 1/2"
SST-1555A	15	10 3/4"	53 1/4"	1 5/8"	1 1/8"	1 1/2"
SST-2005A	20	10 3/4"	65 1/4"	2 1/8"	1 1/8"	2"
SST-2026A	20	12 3/4"	65 1/4"	2 1/8"	1 1/8"	2"
SST-2505A	25	10 3/4"	65 1/2"	2 1/8"	1 3/8"	2 1/2"
SST-2527A	25	12 3/4"	65 1/2"	2 1/8"	1 3/8"	2 1/2"
SST-3005A	30	10 3/4"	65 1/4"	2 5/8"	1 3/8"	2 1/2"
SST-3028A	30	12 3/4"	65 1/2"	2 5/8"	1 3/8"	2 1/2"

ELT Series Compact Tube-in-Tube Condensers



Pumpdown values are calculated at 80% of receiver volume. Use the following multipliers for refrigerants other than shown below:

- R-12 = R-22 capacity x 1.10
- R-502 = R-22 capacity x 1.01
- R-404a = R-22 capacity x 0.89
- R-507 = R-22 capacity x 0.88

Mfg Part No	Nominal HP	Dimensions (in)		
		Depth	Length	Height
ELT-100A	1	2-7/8	21-1/2	11
ELT-150A	1-1/2	2-7/8	21-1/2	11
ELT-200A	2	2-7/8	27	12-5/8
ELT-300A	3	4-1/4	27	17-3/4
ELT-500A	5	4-1/4	27	17-3/4
ELT-800A	8	5-1/2	27-1/2	22-1/4
ELT-1000A	10	5-1/2	27-1/2	22-1/4

VSE Series Vertical Shell & Coil Condensers



Vertical super efficient condenser. Compact design, generous pumpdown. Small package applications.

FEATURES:

- Sealed construction, vertical, shell and coil design
- Greatest refrigerant pumpdown capacity in an upright compact package
- Special "T" models have auxiliary connection for tower applications or to reduce pressure drops
- Size and efficiency make it ideal for use in small package units; ice makers, vending machines, self contained refrigeration cases
- 11 VSE models, 1/2 thru 20 horsepower

Mfg Part No	Nom. HP	Dia.	Height	Refrig. (IDS)		Water (FPT)	
				Inlet	Outlet	City	Tower
VSE-1/2	1/2	6"	5"	1/2"	1/2"	1/2"	—
VSE-1	1	6"	5 1/2"	5/8"	1/2"	1/2"	—
VSE-1-1/2	1 1/2	8 5/8"	6 3/8"	5/8"	1/2"	3/4"	—
VSE-2	2	9 3/4"	7 1/4"	5/8"	5/8"	3/4"	—
VSE-3	3	6 5/8"	13"	7/8"	5/8"	3/4"	—
VSE-5	5	8 5/8"	13 1/2"	1 1/8"	5/8"	1"	—

STANDARD REFRIGERATION

Albany, NY	518-489-0010	Rochester, NY	585-482-3876	Allentown, PA	610-437-9818	Scranton, PA	570-346-1565
Binghamton, NY	607-724-2451	Syracuse, NY	315-475-3131	Altoona, PA	814-941-7617	Stroudsburg, PA	570-424-5724
Buffalo, NY	716-853-1291	Utica, NY	315-732-4077	Erie, PA	814-459-4559	Wilkes-Barre, PA	570-824-8779
Middletown, NY	845-733-5666			Harrisburg, PA	717-558-0828	Williamsport, PA	570-323-4606

STANDARD REFRIGERATION

Receivers



RBV Series Horizontal Design with Brackets and Valves



Pumpdown values are calculated at 80% of receiver volume. Use the following multipliers for refrigerants other than shown below:

- R-12 = R-22 capacity x 1.10
- R-502 = R-22 capacity x 1.01
- R-404a = R-22 capacity x 0.89
- R-507 = R-22 capacity x 0.88

Mfg Part No	Pumpdown Capacity (lbs.)	Dimensions		Connections (IDS)	
	R-22	Dia.	Length	Inlet	Outlet
RBV-285	16	5"	28"	1/2"	1/2"
RBV-366	31	6"	36"	1/2"	1/2"
RBV-3865	39	6 5/8"	38"	5/8"	5/8"
RBV-3685	62	8 5/8"	36"	7/8"	7/8"
RBV-4285	730	8 5/8"	42"	1 1/8"	1 1/8"
RBV-36105	94	10 3/4"	36"	1 1/8"	1 1/8"
RBV-48105	128	10 3/4"	48"	1 1/8"	1 1/8"
RBV-60105	162	10 3/4"	60"	1 1/8"	1 1/8"
RBV-48122	180	12 3/4"	48"	1 3/8"	1 3/8"
RBV-60122	227	12 3/4"	48"	1 3/8"	1 3/8"
RBV-72145	330	14"	72"	1 5/8"	1 5/8"
RBV-96145	444	14"	96"	1 5/8"	1 5/8"
RBV-96166	586	16"	96"	2 1/8"	2 1/8"

Chiller Barrels



TX/TXC Series Super Compact Serviceable Shell and Tube



FEATURES:

- Serviceable
- 30% - 50% smaller than comparable models
- Easier to handle and position
- New advanced design
- UL listed or ASME
- 3/4" insulation
- Single and dual circuit designs
- 3 and 4 circuit designs available
- 21 TX/TXC models from 2 thru 500 tons
- Ideal for OEM replacements

Single Circuit

Mfg Part No	Nominal Tons	Connections		Dimensions		
		Inlet	Outlet	Water (fpt)	Tube Length	Shell Dia.
TX2-1	2	5/8"	7/8"	1"	28 1/4"	2.75"
TX3-1	3	5/8"	7/8"	1"	28 1/4"	2.75"
TX5-1	5	5/8"	1 1/8"	1 1/4"	40 1/4"	4"
TX6-1	6	5/8"	1 1/8"	1 1/2"	40 1/4"	4"
TX7-1/2-1	7.5	7/8"	1 5/8"	1 1/2"	40 1/4"	4"
TX10-1	10	7/8"	1 5/8"	2"	40 1/4"	4"
TX12-1	12	7/8"	1 5/8"	2"	41 1/4"	6"
TX15-1	15	1 1/8"	2 1/8"	2 1/2"	41 1/4"	6"
TX20-1	20	1 1/8"	2 1/8"	3"	41 1/4"	6"
TX25-1	25	1 1/8"	2 5/8"	3"	41 1/4"	6"
TXC30-1	30	1 1/8"	2 5/8"	3 mpt	81 3/4"	6 5/8"
TXC40-1	40	1 3/8"	2 5/8"	3 mpt	81 3/4"	8 5/8"
TXC50-1	50	1 3/8"	3 1/8"	4 fmg	81 3/4"	8 5/8"
TXC60-1	60	1 5/8"	3 1/8"	4 fmg	93 3/4"	8 5/8"
TXC75-1	75	2 1/8"	3 1/8"	5 fmg	93 3/4"	8 5/8"
TXC100-1	100	2 1/8"	3 5/8"	5 fmg	94 7/8"	12 3/4"
TXC120-1	120	2 1/8"	3 5/8"	6 fmg	94 7/8"	12 3/4"

STANDARD REFRIGERATION



STANDARD REFRIGERATION

Chiller Barrels



TX/TXC Series Super Compact Serviceable Shell and Tube

Double Circuit

Mfg Part No	Nominal Tons	Connections			Dimensions	
		Inlet	Outlet	Water (fpt)	Tube Length	Shell Dia
TX10-2	10	5/8"	1 1/8"	2"	40 1/4"	4"
TX12-2	12	5/8"	1 1/8"	2"	41 1/4"	6"
TX15-2	15	7/8"	1 5/8"	2 1/2"	41 1/4"	6"
TX20-2	20	7/8"	1 5/8"	3"	41 1/4"	6"
TXC120-2	120	1 3/8"	3 1/8"	6 fmg	94 7/8"	12 3/4"
TXC30-2	30	7/8"	1 5/8"	3 mpt	81 3/4"	6 5/8"
TXC100-2	100	1 3/8"	3 1/8"	5 fmg	94 7/8"	12 3/4"
TXC40-2	40	1 1/8"	2 1/8"	3 mpt	81 3/4"	8 5/8"
TXC50-2	50	1 1/8"	2 1/8"	4 fmg	81 3/4"	8 5/8"
TXC60-2	60	1 1/8"	2 5/8"	4 fmg	93 3/4"	8 5/8"
TXC75-2	75	1 3/8"	2 5/8"	5 fmg	93 3/4"	8 5/8"
TX25-2	25	7/8"	1 5/8"	3"	41 1/4"	6"

Chiller Builder Kits



CBKIT Low Side Chiller Builder Kits

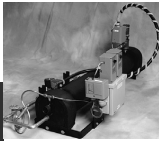

FEATURES:

- Uses compact TX/TXC chiller barrel
- Brand name components
- One, two, three and four circuit options
- NEW three and four circuit models available, ideal for achieving up to 20 tons with single phase compressors
- Available in ranges from two to 75 tons
- Entire kit can be assembled in less than one hour
- Chiller barrel included
- NEW-includes Digital Controls Included components
- Framework
- Temperature controls
- Low pressure switch
- Expansion valve
- Solenoids
- Control power supplies
- Freezestat
- Flow switch
- Sight glasses
- NEW-Includes Digital Controls

Single Circuit

Mfg Part No	Nom. Tons	TX Chiller Barrel	Kit
CBKIT2-1	2	TX2-1	TXKIT1
CBKIT3-1	3	TX3-1	TXKIT2
CBKIT5-1	5	TX5-1	TXKIT2
CBKIT6-1	6	TX6-1	TXKIT3
CBKIT7.5-1	7 1/2	TX7 1/2-1	TXKIT3
CBKIT10-1	10	TX10-1	TXKIT3
CBKIT12-1	12	TX12-1	TXKIT3
CBKIT15-1	15	TX15-1	TXKIT4
CBKIT20-1	20	TX20-1	TXKIT4
CBKIT25-1	25	TX25-1	TXKIT4

Double Circuit

Mfg Part No	Nom. Tons	TX Chiller Barrel	Kit
CBKIT10-2	10	TX10-2	DXTKIT 10-12
CBKIT12-2	12	TX12-2	DXTKIT 10-12
CBKIT15-2	15	TX15-2	DXTKIT 15-20
CBKIT20-2	20	TX20-2	DXTKIT 15-20
CBKIT25-2	25	TX25-2	DXTKIT 15-20

STANDARD REFRIGERATION

Albany, NY	518-489-0010	Rochester, NY	585-482-3876	Allentown, PA	610-437-9818	Scranton, PA	570-346-1565
Binghamton, NY	607-724-2451	Syracuse, NY	315-475-3131	Altoona, PA	814-941-7617	Stroudsburg, PA	570-424-5724
Buffalo, NY	716-853-1291	Utica, NY	315-732-4077	Erie, PA	814-459-4559	Wilkes-Barre, PA	570-824-8779
Middletown, NY	845-733-5666			Harrisburg, PA	717-558-0828	Williamsport, PA	570-323-4606

STANDARD REFRIGERATION

Brackets

Standard
REFRIGERATION COMPANY

Compressor/Condenser Brackets



Mfg Part No	Dimensions
BR1	6" x 14"
BR3	6 5/8" x 14"
BR5	8 5/8" x 14"
BR7	10 3/4" x 14"
BR9	12 3/4" x 14"
BR10	14" x 24"
BR11	16" x 24"
BR12	18" x 24"
BR13	20" x 24"

Universal Brackets

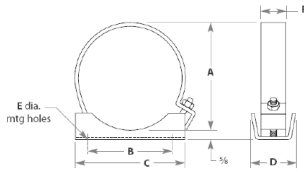

Mfg Part No	Dimensions					
	A	B	C	D	E	F
5A	5"	5 1/2"	7"	2 9/16"	7/16"	1 1/16"
6A	6"	5 1/2"	7"	2 9/16"	7/16"	1 1/16"
6B	6 5/8"	5 1/2"	7"	2 9/16"	7/16"	1 1/16"
8B	8 5/8"	8"	9"	2 7/8"	7/16"	1 1/16"
10B	10 3/4"	10"	11"	3 5/16"	7/16"	1 1/16"
12B	12 3/4"	11 5/8"	13"	4 1/8"	9/16"	1 1/2"
14B	14"	13 1/4"	14 1/2"	4 1/8"	9/16"	1 1/2"
16B	16"	15 3/4"	17"	4 1/8"	9/16"	1 1/2"

Accessories

Standard
REFRIGERATION COMPANY

Rotalock Valves

Left Gage Port



Use stem end of valve & coupling connection as reference when determining gage port position.

Mfg Part No	Connections			Body Size
	Body	Coupling		
H03FL	3/8 flare	3/4 - 16		3/4 hex
H04FL	1/2 flare	1 - 14		7/8 square
H05FL	5/8 flare	1 - 14		7/8 square
H04SL	1/2 ids	1 - 14		7/8 square
H05SL	5/8 ids	1 - 14		7/8 square
H07SL	7/8 ids	1-1/4 - 12		1-1/8 square
H09SL	1-1/8 ids	1-1/4 - 12		1-1/8 square
H11SL	1-3/8 ids	1-3/4 - 12		1-1/8 square

STANDARD REFRIGERATION

STANDARD REFRIGERATION

Accessories



Rotalock Components

Brass Adapter



Mfg Part No	Connections				Height (in)
	IDS (in)	ODS (in)	Thread		
BA03X06	3/8	1/2	3/4-16		1-5/16
BA03X08	3/8	1/2	1-14		1-5/16
BA04X08	1/2	5/8	1-14		1-5/16
BA05X08	5/8	7/8	1-14		1-5/16
BA05X10	5/8	7/8	1-1/4-12		1-9/16
BA07X10	7/8	1-1/8	1-1/4-12		1-9/16
BA09X10	1-1/8	1-3/8	1-1/4-12		1-9/16
BA09X14	1-1/8	1-3/8	1-3/4-12		1-11/16
BA11X14	1-3/8	1-5/8	1-3/4-12		1-11/16

Teflon Fiber Seal



Mfg Part No	ID (in)	OD (in)	Use w/Thread	Height (in)
TS-24590	7/16	9/16	3/4-16	1/16
TS-24591	5/8	3/4	1-14	1/16
TS-24592	7/8	1	1-1/4-12	1/16
TS-24953	1-3/8	1-1/2	1-3/4-12	1/16

STANDARD REFRIGERATION

We've got the information you're looking for!

Visit our web site at www.MeierSupply.com

At www.MeierSupply.com, we have a wealth of data available 24 hours a day!

- ***Business & technical articles***
- ***The Meier Minute newsletter***
- ***Contact information for our branches***
- ***Technical tips***
- ***Product updates and branch training***
- ***Links to vendors***
- ***Employment opportunities***
- ***Box load calculation***

Albany, NY	518-489-0010	Rochester, NY	585-482-3876	Allentown, PA	610-437-9818	Scranton, PA	570-346-1565
Binghamton, NY	607-724-2451	Syracuse, NY	315-475-3131	Altoona, PA	814-941-7617	Stroudsburg, PA	570-424-5724
Buffalo, NY	716-853-1291	Utica, NY	315-732-4077	Erie, PA	814-459-4559	Wilkes-Barre, PA	570-824-8779
Middletown, NY	845-733-5666			Harrisburg, PA	717-558-0828	Williamsport, PA	570-323-4606